

Stroke Sensing Cylinder

Feature

- Absolute position output, 0.1 mm high resolution
- Impact resistance for hydraulic excavator
- Interchangeable with standard cylinder (depending on size)

MTS Position Sensor (Design for KCH)

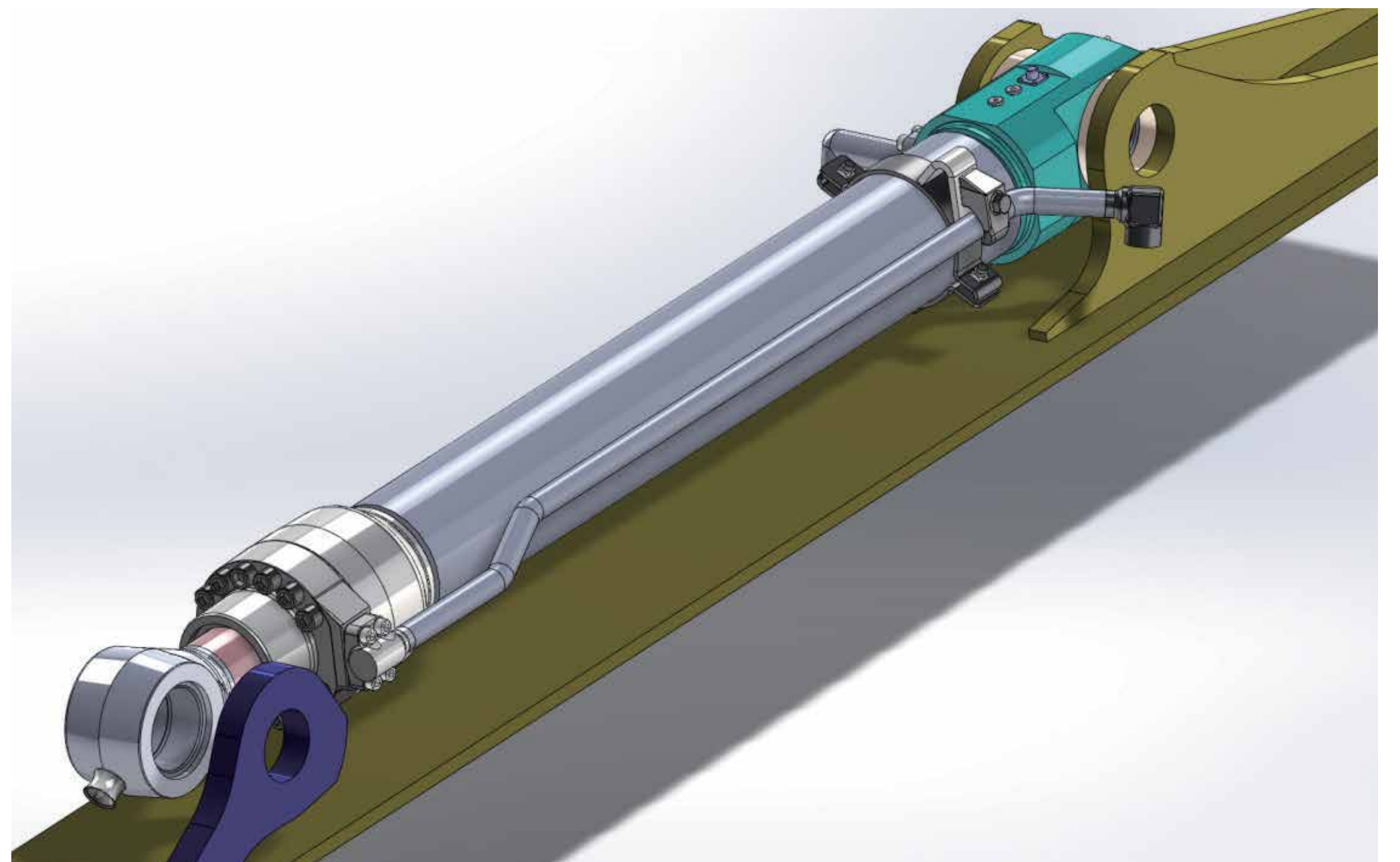

Cylinder

- Max. pressure: 35 MPa [Max. peak 45 MPa]
- Max. piston speed: Equivalent to standard cylinders
- Hydraulic oil temperature: -20°C~100°C
[Ambient temperature: -40°C~105°C]

Electricity

- Power supply: 12 VDC, 24 VDC
[Electric power consumption 1.5 W or less]
- Output connector shape: M12 connector [5 pins]
- Output connector location: Top surface of the cylinder base

Output

- Output items: Piston position, Piston speed [Simultaneous output]
- Output format: CAN [SAE J1939 Sampling 10ms~20ms flexible]
- Accuracy $\pm 0.04\%$ Linearity, $\pm 0.05\%$ mm accuracy*, 0.1 mm resolution

Environment

- Vibration resistance: Max. 70G each axis
[Max. acceleration at vibration test]*
- Impact resistance: Max. 100G
[Max acceleration at 100 thousand cycles impact durability test]*
- Ingress Protection code: IP69K [with IP69K harness at connector]

*Accuracy, vibration resistance, and impact resistance are actual elevated value by KYB

